

LOT 4, VALLEY OAK SUBDMISION  
VOLUME 7, PAGE 265, PLAT RECORDS OF HAYS COUNTY, TEXAS

8151 W. FITZHUGH ROAD    DRIPPING SPRINGS, TEXAS

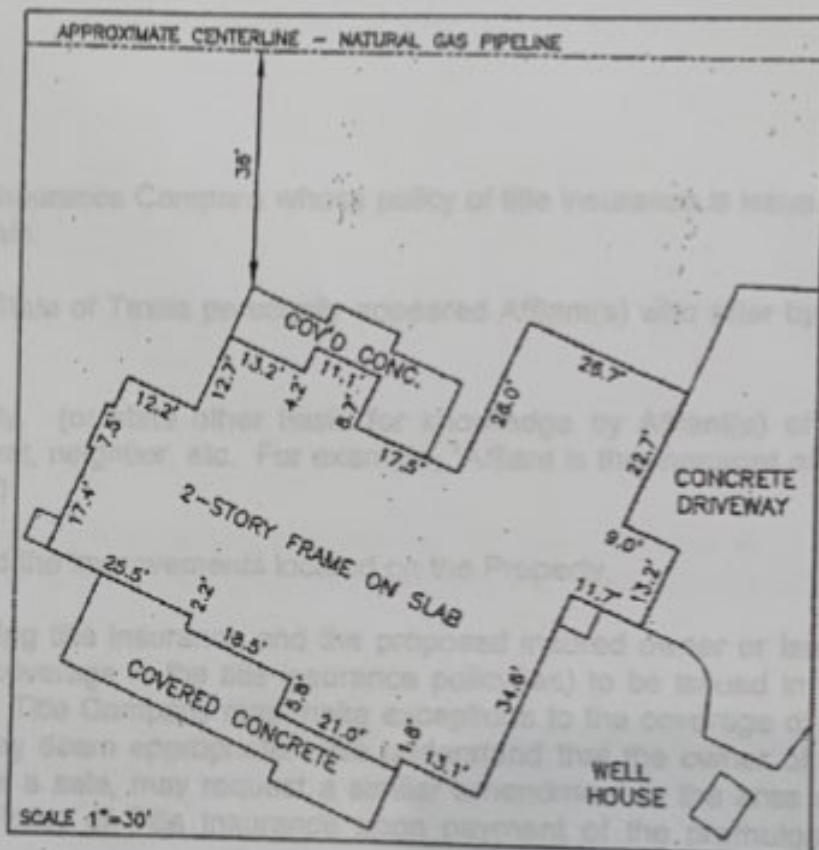

EASEMENT SUMMARY: (OF: 19-0279-0)  
 BESIDES THOSE EASEMENTS SHOWN HEREON, THE  
 FOLLOWING ITEMS MAY AFFECT THIS TRACT, THE  
 LOCATION OF WHICH CANNOT BE DETERMINED.

- 10.i. GAS PIPELINES AS SHOWN ON PLAT [7/265]  
10.g. SHELL PIPELINE EASEMENT [97/420 D.R.]  
10.h. HUMBLE PIPELINE EASEMENT [145/351 D.R.]  
10.j. EASEMENT RIGHTS [1254/208 O.P.R.]

LEGEND

- 1/2 INCH IRON ROD FOUND  
○ UTILITY POLE  
— OH — OVERHEAD UTILITY LINE  
( ) RECORD INFORMATION



A COMPLETE SEARCH OF THE PUBLIC RECORD HAS NOT BEEN CONDUCTED. EASEMENTS NOT SHOWN HEREON MAY AFFECT THIS TRACT.

I HEREBY CERTIFY THAT THIS PLAT IS BASED ON AN ACTUAL ON THE GROUND SURVEY AND THAT THE LINES AND CORNERS ARE TRUE AND CORRECT TO THE BEST OF MY KNOWLEDGE AND BELIEF.

KEVIN MUELLER  
105 N. COCKRELL ST.  
(512) 492-5502  
KEVINMUELLER@SUNTO

5-1-19

SAW TOOTH SURVEY  
P.O. BOX 1751  
ALPINE, TX 79831